

# Soils Map

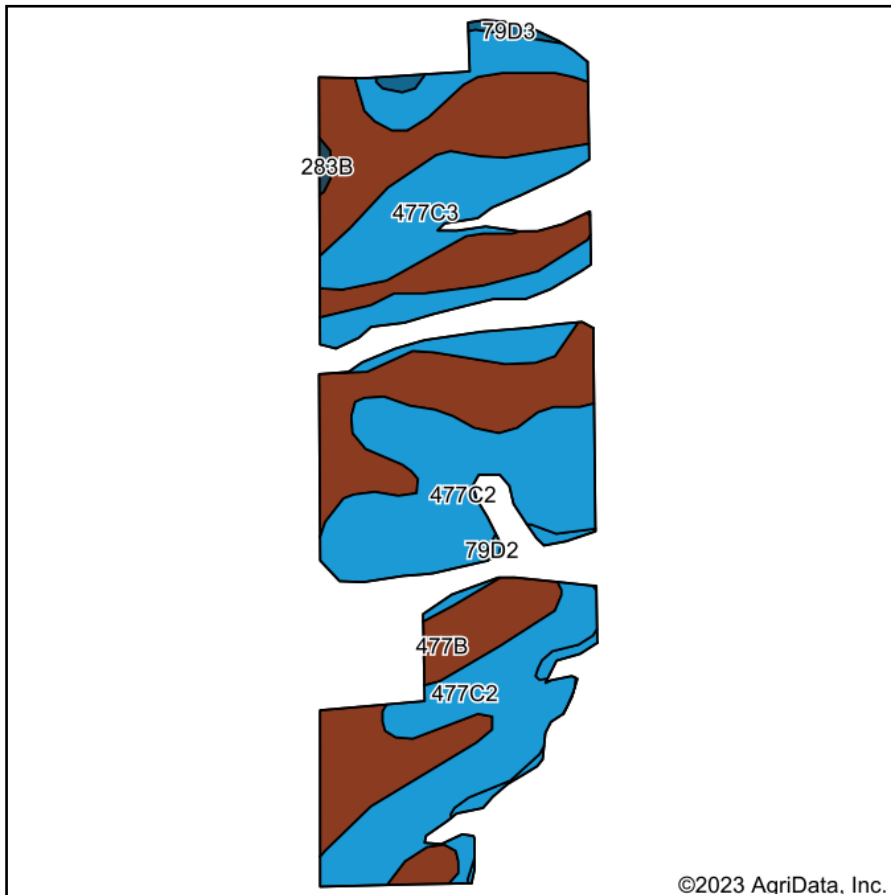

Soils data provided by USDA and NRCS.

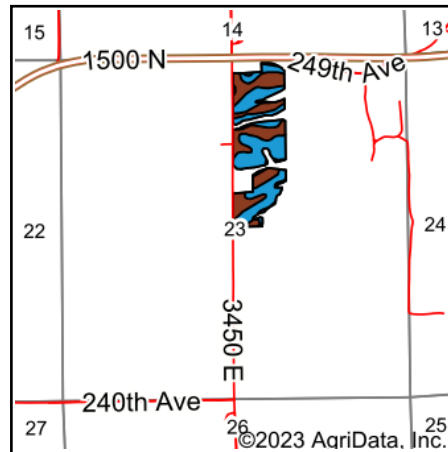

State: **Illinois**  
 County: **Pike**  
 Location: **23-5S-3W**  
 Township: **Newburg**  
 Acres: **35.96**  
 Date: **2/17/2023**

**CURLESS AUCTION**

Maps Provided By:



© AgriData, Inc. 2021

www.AgriDataInc.com



Area Symbol: IL149, Soil Area Version: 17

| Code                    | Soil Description  | Acres | Percent of field | Il. State Productivity Index Legend | Subsoil rooting <b>a</b> | Corn Bu/A    | Soybeans Bu/A | Wheat Bu/A  | Oats Bu/A <b>b</b> | Sorghum <b>c</b> Bu/A | Alfalfa <b>d</b> hay, T/A | Grass-legume <b>e</b> hay, T/A | Crop productivity index for optimum management |
|-------------------------|---|-------|------------------|-------------------------------------|--------------------------|--------------|---------------|-------------|--------------------|-----------------------|---------------------------|--------------------------------|--|
| **477B                  | Winfield silt loam, 2 to 5 percent slopes                         | 15.16 | 42.2%            |                                     | FAV                      | **160        | **50          | **62        | 0                  | **122                 | **4.97                    | 0.00                           | **118  |
| **477C2                 | Winfield silt loam, 5 to 10 percent slopes, eroded                | 12.51 | 34.8%            |                                     | FAV                      | **151        | **47          | **59        | 0                  | **114                 | **4.67                    | 0.00                           | **111  |
| **477C3                 | Winfield silty clay loam, 5 to 10 percent slopes, severely eroded | 7.37  | 20.5%            |                                     | FAV                      | **139        | **43          | **54        | 0                  | **106                 | **4.32                    | 0.00                           | **102  |
| **79D2                  | Menfro silt loam, 10 to 18 percent slopes, eroded                 | 0.51  | 1.4%             |                                     | FAV                      | **147        | **45          | **56        | 0                  | **109                 | **4.35                    | 0.00                           | **107  |
| **79D3                  | Menfro silty clay loam, 10 to 18 percent slopes, severely eroded  | 0.31  | 0.9%             |                                     | FAV                      | **134        | **41          | **51        | 0                  | **99                  | **3.96                    | 0.00                           | **97   |
| **283B                  | Downsouth silt loam, 2 to 5 percent slopes                        | 0.10  | 0.3%             |                                     | FAV                      | **182        | **56          | **69        | 0                  | **127                 | **6.34                    | 0.00                           | **135  |
| <b>Weighted Average</b> |   |       |                  |                                     |                          | <b>152.2</b> | <b>47.4</b>   | <b>59.2</b> | <b>*</b>           | <b>115.6</b>          | <b>4.72</b>               | <b>0.00</b>                    | <b>112</b>                                     |

**Table: Optimum Crop Productivity Ratings for Illinois Soil by K.R. Olson and J.M. Lang, Office of Research, ACES, University of Illinois at Champaign-Urbana.** Version: 1/2/2012 Amended Table S2 B811

Crop yields and productivity indices for optimum management (B811) are maintained at the following NRES web site: <http://soilproductivity.nres.illinois.edu/>

\*\* Indexes adjusted for slope and erosion according to Bulletin 811 Table S3

**a** UNF = unfavorable; FAV = favorable

**b** Soils in the southern region were not rated for oats and are shown with a zero "0".

**c** Soils in the northern region or in both regions were not rated for grain sorghum and are shown with a zero "0".

**d** Soils in the poorly drained group were not rated for alfalfa and are shown with a zero "0".

**e** Soils in the well drained group were not rated for grass-legume and are shown with a zero "0".

Soils data provided by USDA and NRCS. Soils data provided by University of Illinois at Champaign-Urbana.